

Specification

| | | | |
|---|--------------------|-----------|------|
| Nominal Voltage | 12 volts | | |
| Nominal Capacity | 77° F (25° C) | | |
| 20-hr. (1.30A) | 26 Ah | | |
| 10-hr. (2.42A) | 24.18 Ah | | |
| 5-hr. (4.42A) | 22.10 Ah | | |
| 1-hr. (15.60A) | 15.60 Ah | | |
| Approximate Weight | 18.1 lbs (8.2 kgs) | | |
| Internal Resistance (approx.) | 14mΩ | | |
| Shelf Life (% of normal capacity at 77° F (25° C)) | | | |
| 3 Months | 6 Months | 12 Months | |
| 91% | 82% | 64% | |
| Temperature Dependency of Capacity | (20 hour rate) | | |
| 104° F | 77° F | 32° F | 5° F |
| 102% | 100% | 85% | 65% |
| AGM Operational Temperature | -20°C to 45°C | | |
| AGM Storage Temperature | -20°C to 45°C | | |



Charge Method (Constant Voltage)

Cycle Use (Repeating Use)

| | |
|-----------------|------------------|
| Initial Current | 7.8 A or smaller |
| Control Voltage | 14.5 - 14.9 V |

Float Use

| | |
|-----------------|---------------|
| Control Voltage | 13.6 - 13.8 V |
|-----------------|---------------|

Physical Dimensions: in (mm)

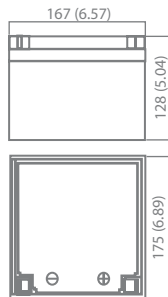

L: 6.57in (166.9 mm)
W: 6.89in (175 mm)
H: 5.04in (128 mm)
TH: 5.04in (128 mm)

Tolerances are +/- 0.04 in. (+/- 1mm) and +/- 0.08 in. (+/- 2mm) for height dimensions. All data subject to change without notice.

Terminals (T3)

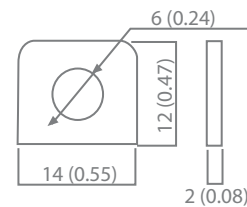

Discharge Time vs. Discharge Current

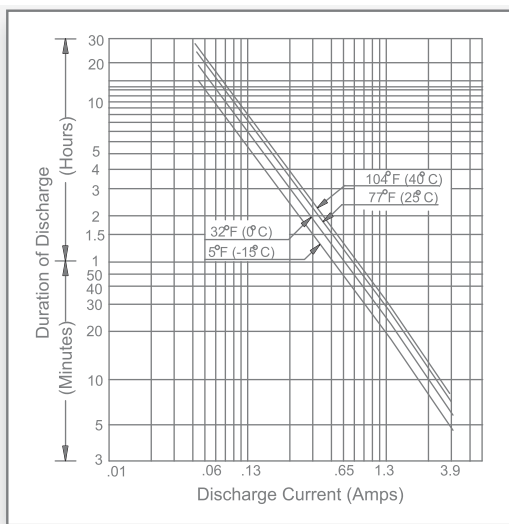

Discharge Characteristics

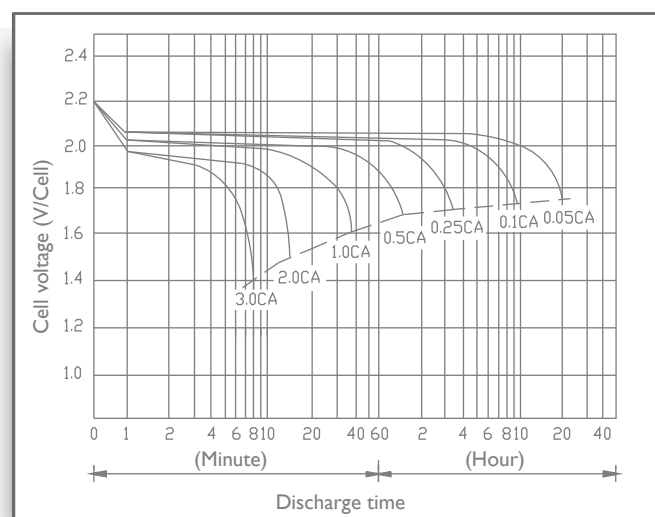

Shelf Life & Storage

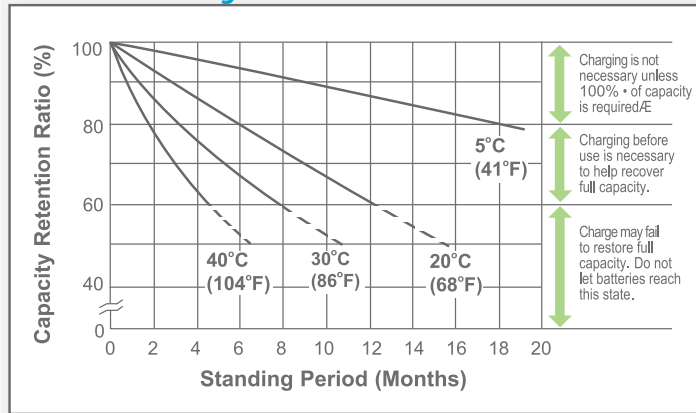

Cycle Life vs Depth of Discharge

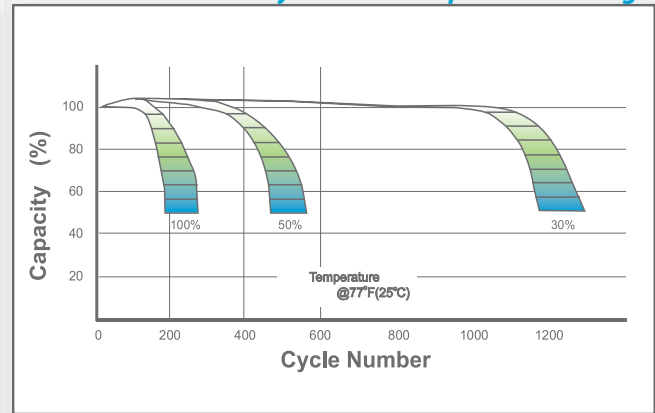

Open Circuit Voltage vs Residual Capacity

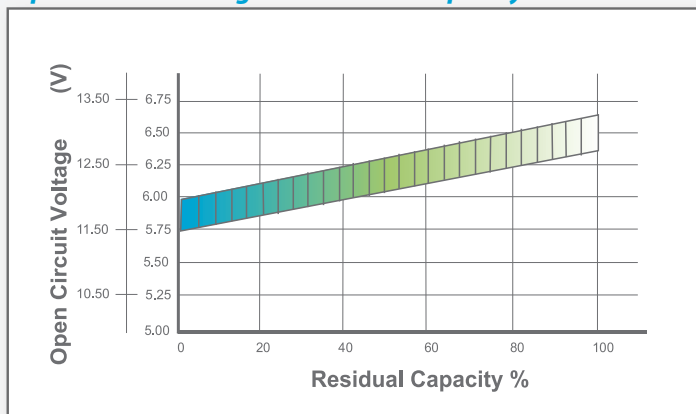

Effect of Temperature on Capacity

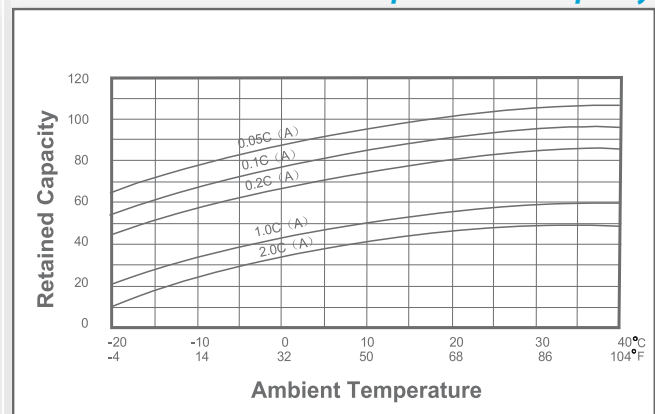

Charge Current & Final Discharge Voltage

| Application | Charge Voltage (V/Cell) | | | Max. Charge Current | Final Discharge Voltage V/Cell | 1.75 | 1.70 | 1.60 | 1.30 |
|-------------|-------------------------|-----------|-----------------|---------------------|--------------------------------|------------|-------------------|-------------------|------------|
| | Temperature | Set Point | Allowable Range | | | | | | |
| Cycle Use | 25°C (77°F) | 2.45 | 2.40-2.50 | 0.30C | Discharge Current (A) | 0.2C > (A) | 0.2C < (A) < 0.5C | 0.5C < (A) < 1.0C | (A) > 1.0C |
| Standby | 25°C (77°F) | 2.325 | 2.30-2.35 | | | | | | |

