

UB1222

Maintenance-Free



POWERSTRIDE BATTERY

Specification

Nominal Voltage	12 volts		
Nominal Capacity	77° F (25° C)		
20-hr. (0.11A)	2.2 Ah		
10-hr. (0.2 A)	2 Ah		
5-hr. (0.37 A)	1.87 Ah		
1-hr. (1.3 A)	1.3 Ah		
Max Charge Current (A)	0.66A		
	1.38 Ah		
Approximate Weight	2.14 lbs (0.97 kgs)		
Internal Resistance (approx.)	80mΩ		
Shelf Life (% of normal capacity at 77° F (25° C))			
3 Months	6 Months	12 Months	
91%	82%	64%	
Temperature Dependency of Capacity	(20 hour rate)		
104° F	77° F	32° F	5° F
102%	100%	85%	65%



Charge Method (Constant Voltage)

Cycle Use (Repeating Use)

Initial Current	0.66 A or smaller
Control Voltage	14.5 - 14.9 V

Float Use

Control Voltage	13.6 - 13.8 V
-----------------	---------------

Physical Dimensions: in (mm)

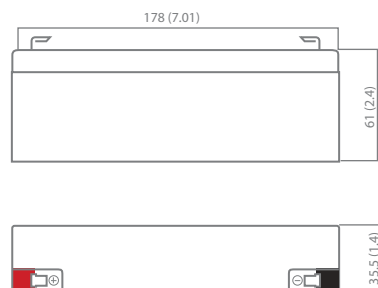

L: 7.01in (178 mm)
W: 1.4in (35.5 mm)
H: 2.4in (61 mm)
TH: 2.6in (66 mm)

Tolerances are +/- 0.04 in. (+/- 1mm) and +/- 0.08 in. (+/- 2mm) for height dimensions. All data subject to change without notice.

Terminals

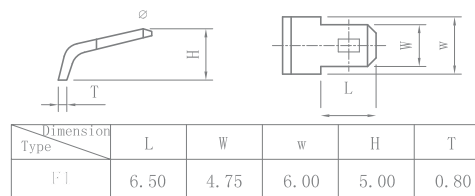

Discharge Time vs. Discharge Current

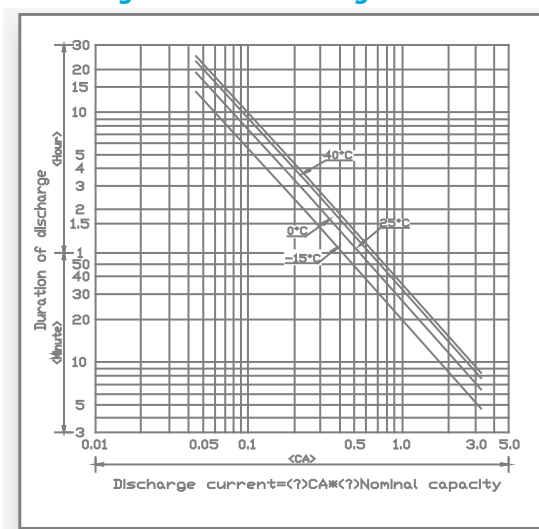

Discharge Characteristics

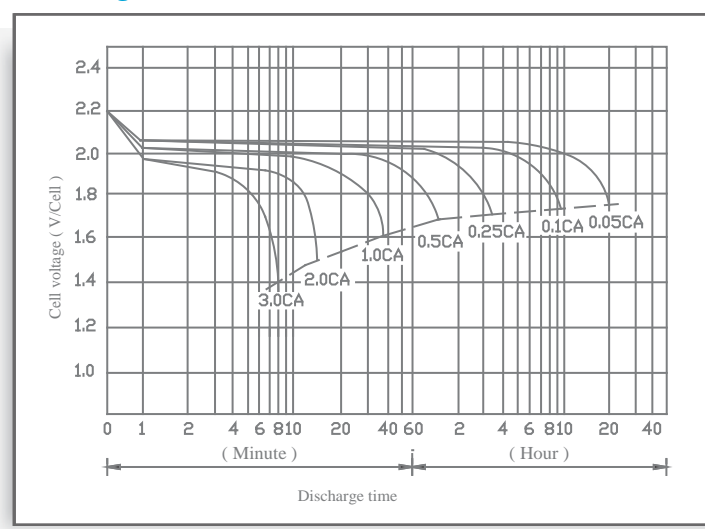

Battery Charging Characteristics for Cyclic Use

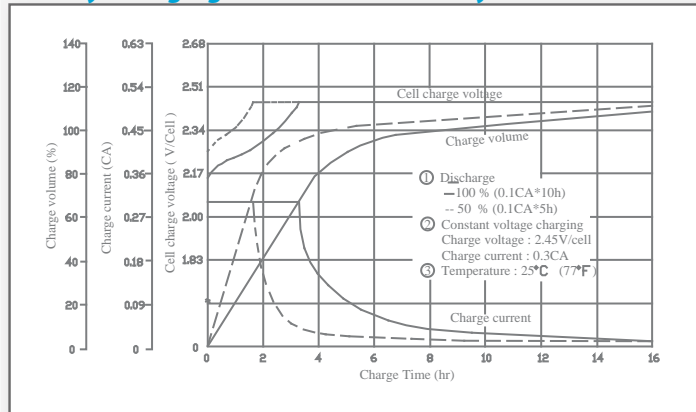

Battery Charging Characteristics for Standby Use

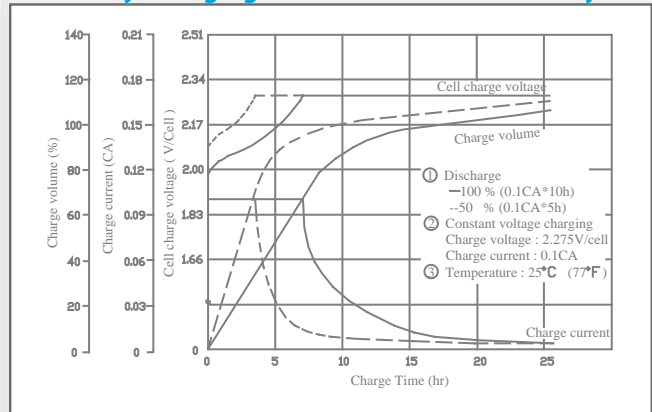

Shelf Life & Storage

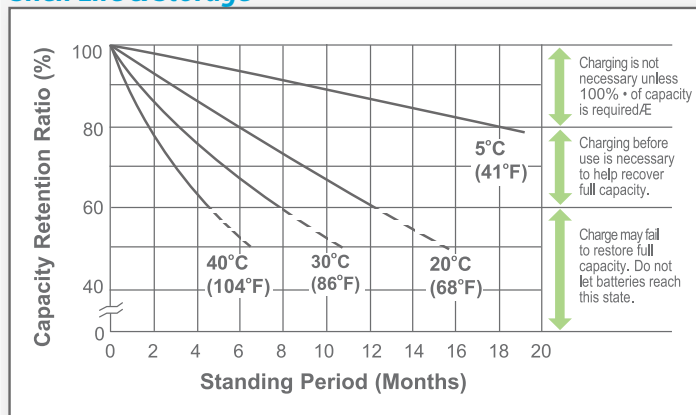

Cycle Life vs Depth of Discharge

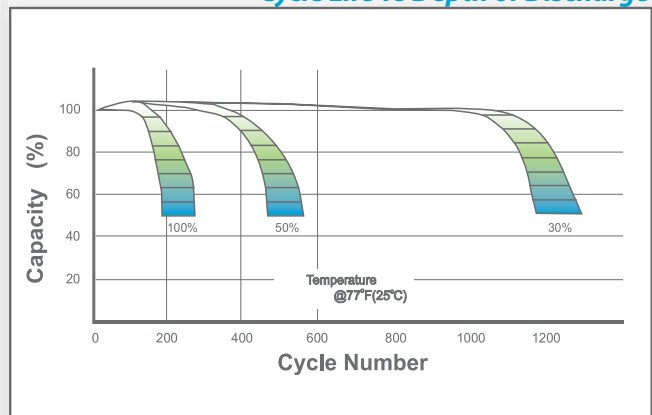

Open Circuit Voltage vs Residual Capacity

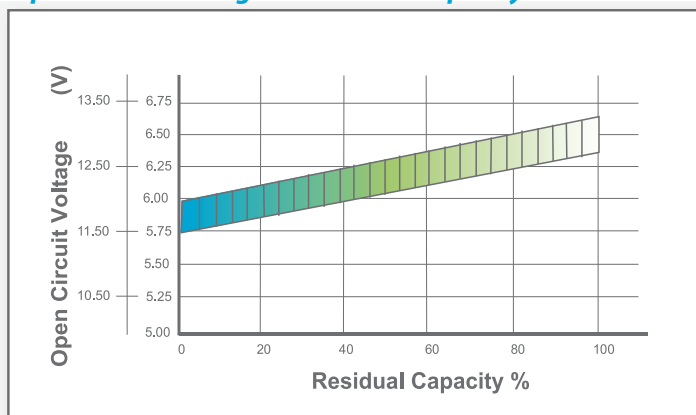

Effect of Temperature on Capacity

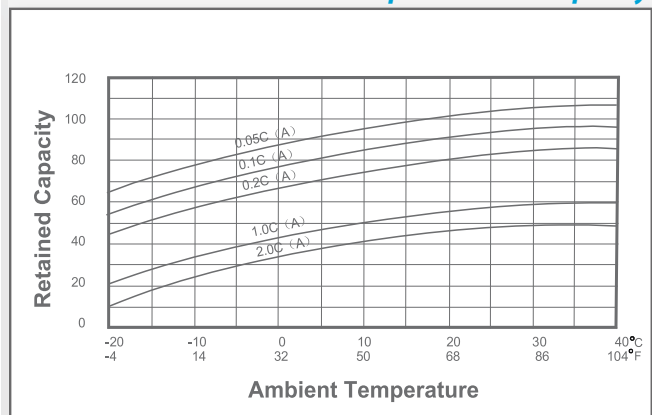

Charge Current & Final Discharge Voltage

Application	Charge Voltage(V/Cell)			Max.Charge Current	Final Discharge Voltage V/Cell	1.75	1.70	1.60	1.30
	Temperature	Set Point	Allowable Range						
Cycle Use	25°C(77°F)	2.45	2.40~2.50	0.30C	Discharge	0.2C>(A)	0.2C<(A)<0.5C	0.5C<(A)<1.0C	(A)>1.0C
Standby	25°C(77°F)	2.30	2.27~2.30		Current(A)				