

UB685

Maintenance-Free



Specification

Nominal Voltage	6 volts		
Nominal Capacity			
20-hr. (0.42A)	8.5 Ah		
10-hr. (0.79A)	7.9 Ah		
5-hr. (1.44A)	7.2 Ah		
1-hr. (5.1A)	5.1 Ah		
Approximate Weight	3.3 lbs (1.5 kgs)		
Internal Resistance (approx.)	12mΩ		
Max Charge Current (A)	2.5 A		
Case	ABS Plastic		
Shelf Life (% of normal capacity at 77° F (25° C))			
3 Months	6 Months	12 Months	
91%	82%	64%	
Temperature Dependency of Capacity	(20 hour rate)		
104° F	77° F	32° F	5° F
102%	100%	85%	65%
AGM Operational Temperature			
Charge	0°C to 40°C		
Discharge	-15°C to 45°C		
AGM Storage Temperature	-15°C to 40°C		



Charge Method (Constant Voltage)

Cycle Use (Repeating Use)

Initial Current	2.5 A or smaller
Control Voltage	7.3 - 7.4 V

Float Use

Control Voltage	6.8 - 6.9 V
-----------------	-------------

Physical Dimensions: in (mm)

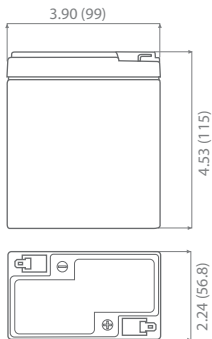

L: 3.90 in (99 mm)
W: 2.24 in (56.8 mm)
H: 4.53 in (115 mm)
TH: 4.53 in (115 mm)
 Tolerances are +/- 0.04 in. (+/- 1mm) and +/- 0.08 in. (+/- 2mm) for height dimensions. All data subject to change without notice.

Terminals

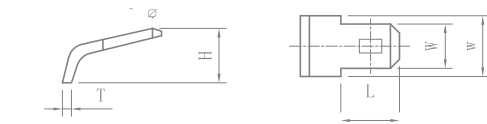

Dimension Type	L	W	w	H	T
F1	6.50	4.75	6.00	5.00	0.80

Discharge Time vs. Discharge Current

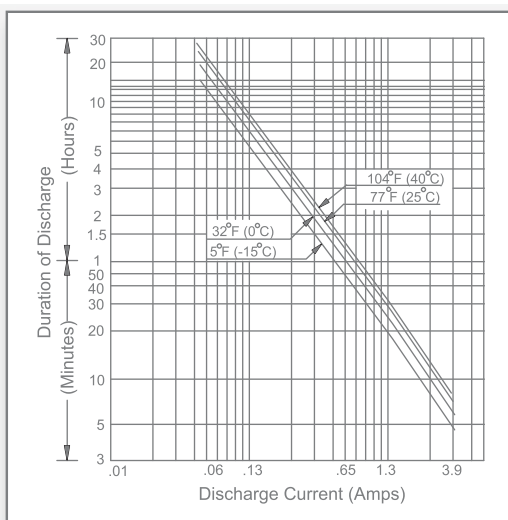

Discharge Characteristics

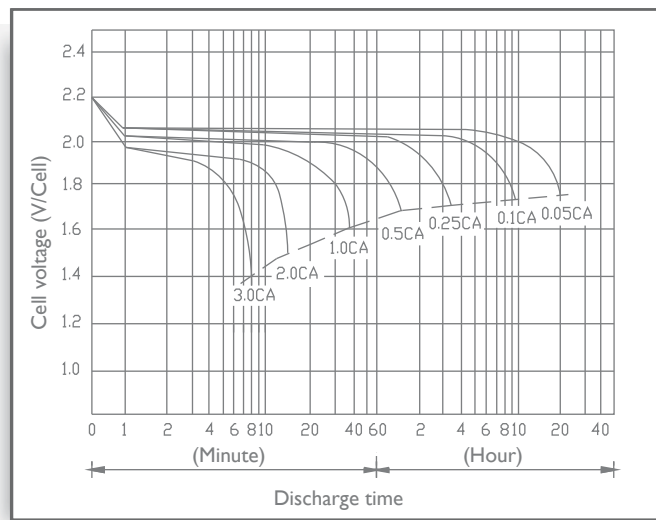

Battery Charging Characteristics for Standby Use

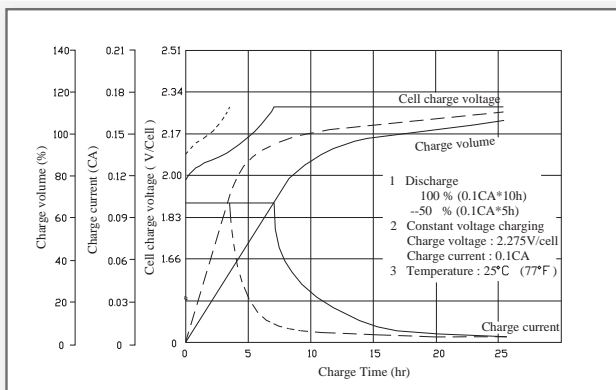

Battery Charging Characteristics for Cyclic Use

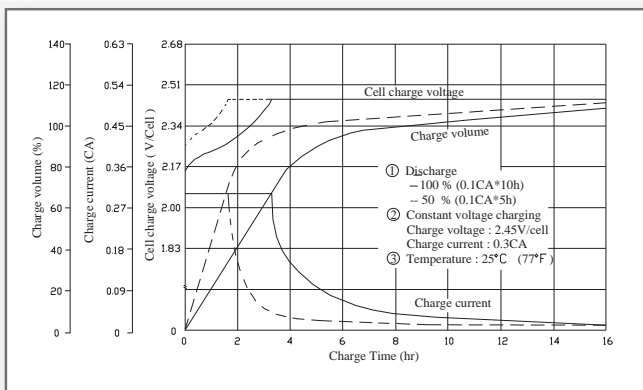

Shelf Life & Storage

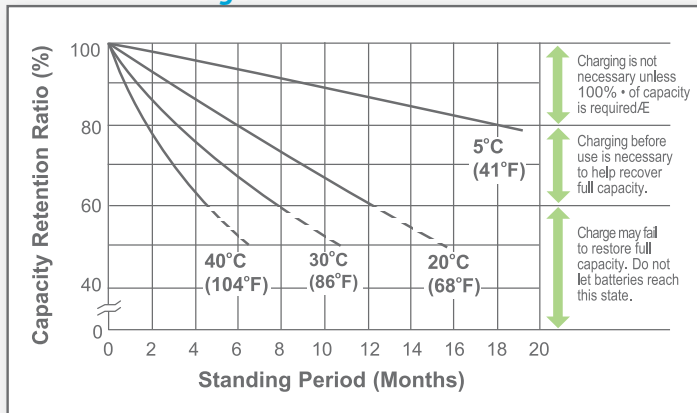

Cycle Life vs Depth of Discharge

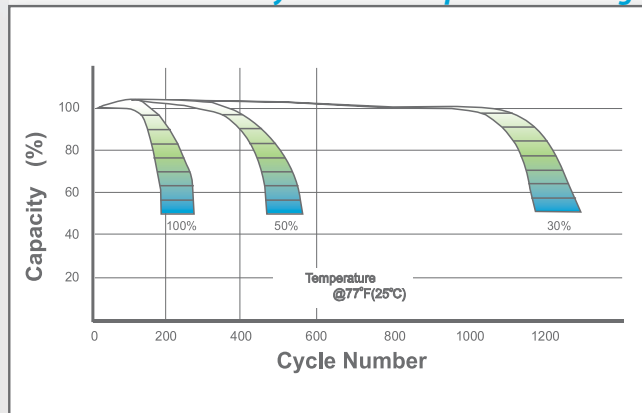

Open Circuit Voltage vs Residual Capacity

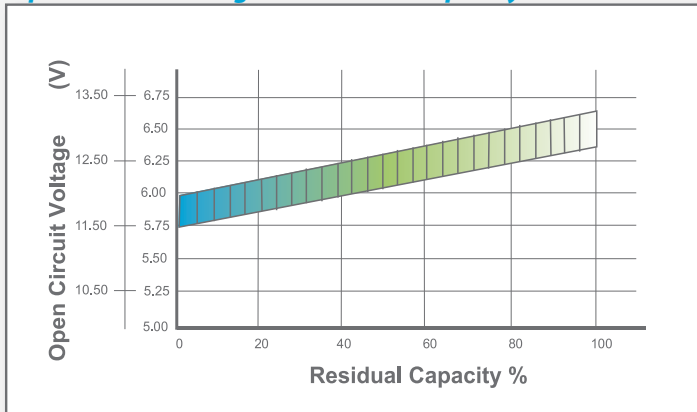

Effect of Temperature on Capacity

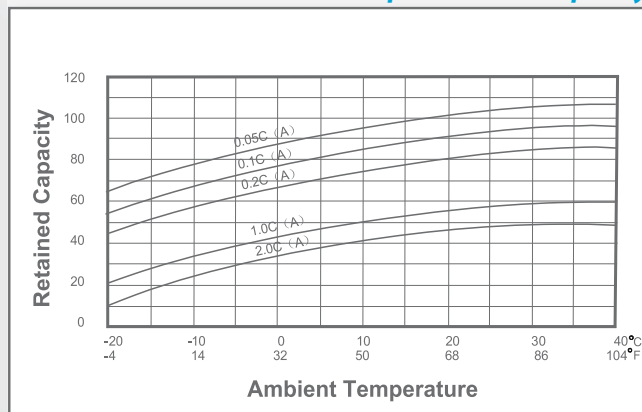

Charge Current & Final Discharge Voltage

Application	Charge Voltage(V/Cell)			Max.Charge Current	Final Discharge Voltage V/Cell	Discharge Current(A)
	Temperature	Set Point	Allowable Range			
Cycle Use	25°C(77°F)	2.45	2.40-2.50	0.30C	1.75	1.70
Standby	25°C(77°F)	2.30	2.27-2.30		1.60	1.30
						0.2C>(A) 0.2C<(A)<0.5C 0.5C<(A)<1.0C (A)>1.0C