

## Specification

<b>Nominal Voltage</b>	12 volts		
<b>Nominal Capacity</b>	77° F (25° C)		
20-hr. (0.90A)	18 Ah		
10-hr. (1.67A)	16.74 Ah		
5-hr. (3.06A)	15.30 Ah		
1-hr. (10.80A)	10.80 Ah		
<b>Approximate Weight</b>	11.9 lbs (5.4 kgs)		
<b>Internal Resistance (approx.)</b>	18mΩ		
<b>Shelf Life (% of normal capacity at 77° F (25° C))</b>			
3 Months	6 Months	12 Months	
91%	82%	64%	
<b>Temperature Dependency of Capacity</b>	(20 hour rate)		
104° F	77° F	32° F	5° F
102%	100%	85%	65%
<b>AGM Operational Temperature</b>			
Charge	0°C to 40°C		
Discharge	-15°C to 45°C		
<b>AGM Storage Temperature</b>	-15°C to 40°C		



### Charge Method (Constant Voltage)

### Cycle Use (Repeating Use)

Initial Current	5.4 A or smaller
Control Voltage	14.5 - 14.9 V

### Float Use

Control Voltage	13.6 - 13.8 V
-----------------	---------------

## Physical Dimensions: in (mm)

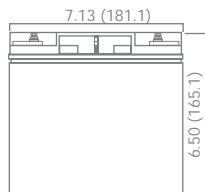

**L:** 7.13in (181.1 mm)  
**W:** 3.01in (76.5 mm)  
**H:** 6.50in (165.1 mm)  
**TH:** 6.50in (165.1 mm)  
 Tolerances are +/- 0.04 in. (+/- 1mm)  
 and +/- 0.08 in. (+/- 2mm) for height  
 dimensions. All data subject to  
 change without notice.



## Terminals

### I Series (Internal Thread Terminal)

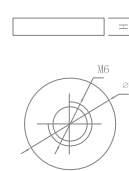

Dimension Type	M	∅	H
I1	6.00 mm 0.24 in	13.0 mm 0.51 in	4.00 mm 0.16 in

## Discharge Time vs. Discharge Current

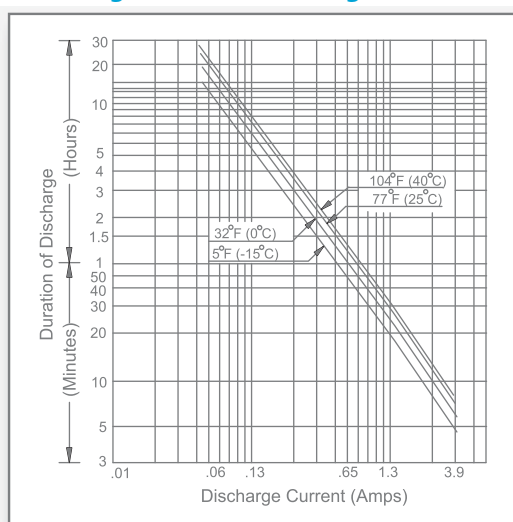

## Discharge Characteristics

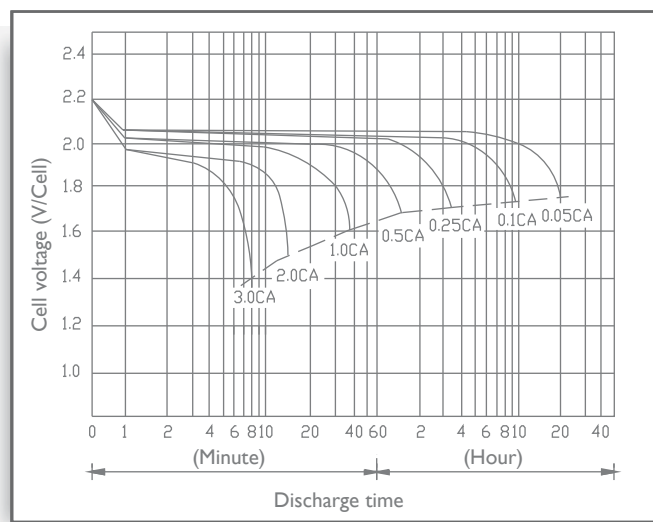

### Shelf Life & Storage

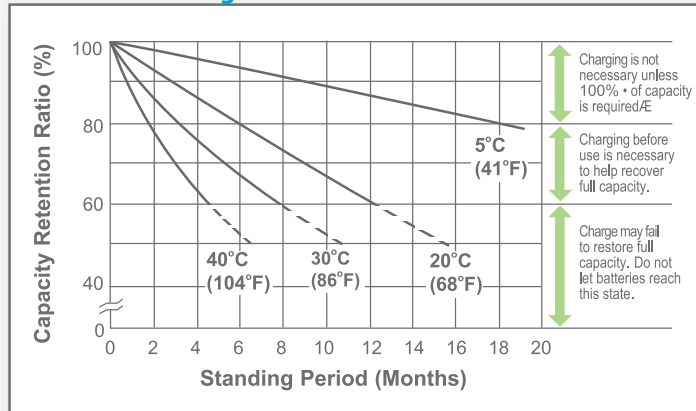

### Cycle Life vs Depth of Discharge

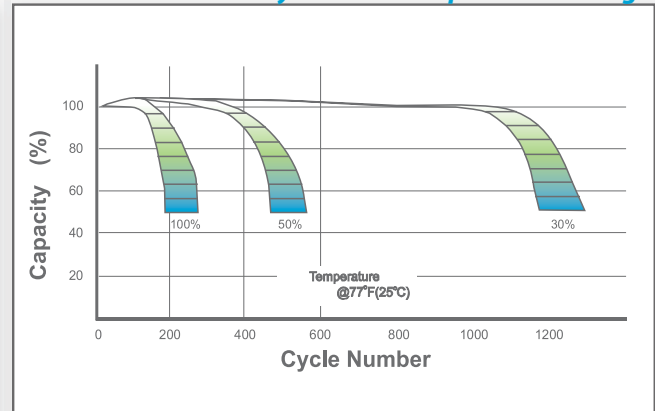

### Open Circuit Voltage vs Residual Capacity

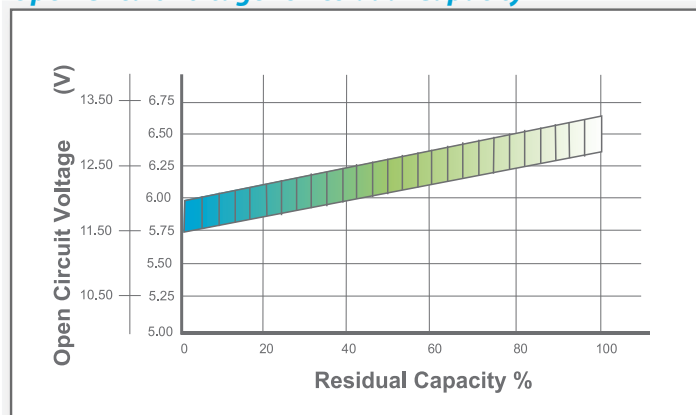

### Effect of Temperature on Capacity

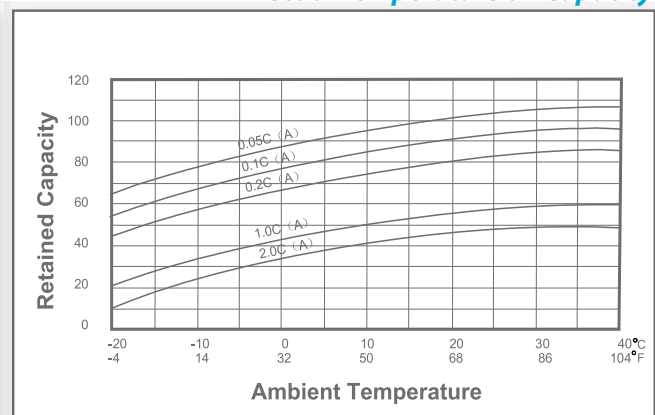

### Charge Current & Final Discharge Voltage

Application	Charge Voltage(V/Cell)			Max.Charge Current	Final Discharge Voltage V/Cell	1.75	1.70	1.60	1.30
	Temperature	Set Point	Allowable Range						
Cycle Use	25°C(77°F)	2.45	2.40-2.48	0.3C	Discharge	0.2C>(A)	0.2C<(A)<0.5C	0.5C<(A)<1.0C	(A)>1.0C
Standby	25°C(77°F)	2.3	2.26-2.32						

